

Refraction unit ELITE



ELITE

CE

Refraction unit ELITE

- Motorized sliding table top for two instruments.
- Elevating table top (25 cm).
- Elevating patient chair (16 cm).
- Removable patient chair for wheelchair access.
- Column with overhead LED lamp with adjustable illumination.
- Column with support for chart projector.

- Integrated adjustable power transformers for slit lamp/ophthalmometer.
- Chin rest support plates.
- 230V outlet for additional instrument e. g. auto lensmeter, auto phoropter, etc.
- Head rest for the chair.
- Cable drag chain for data cables.
- Safety switches for horizontal and vertical movement of the table.

Optional

- Motorized phoropter arm.
- Foot rest (either fixed or foldable).
- Foldable arm rests.
- Chair with reclining back.
- Manual (13cm) or motorized (14cm) chair sliding forward – backwards.
- Foot switch control for up/down movement of the chair.
- Installed data cables (Fire Wire, USB, RS232, etc.).
- Pillow for children.
- Doctor's desk according customer specifications.
- Left-handed version.

Refraction unit

Mystrus

Refraction unit ELITE

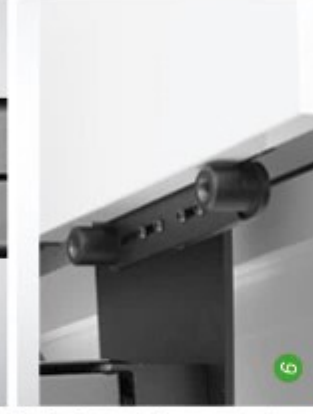

1. Drawer for Trial lenses set.
2. Motorized phoropter arm and overhead lamp.
3. Motorized chair sliding assembly.
4. Operational panel.
5. Elevating table top.
6. Adjustable adapter for chin rest.



Technical information

Voltage	~230V 50/60Hz
Total weight	210 kg
Max height	186 cm
Table height from the ground	From 73cm to 98cm (25cm lift)
Chair height from the ground*	From 48cm to 63cm (15cm lift)
Chair rotation*	360°
Overhead LED lamp	2x12V 5W
Instruments power supply	~230V, ~12V adj., ~6V adj.

*Can vary depending on options.

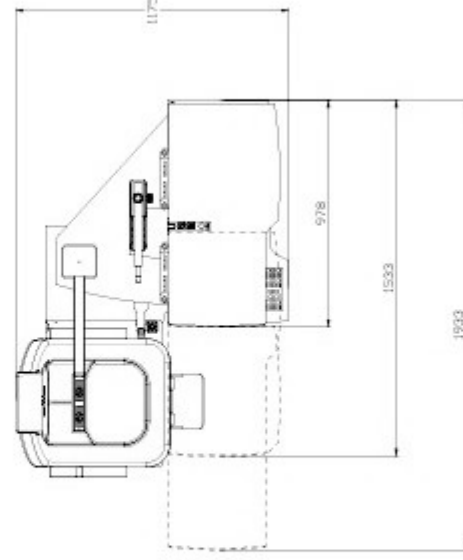

UAB „Medinstrus“
Kruocių g. 9, Kruocių k.
LT-89327 Mėzėikių r.
Lithuania

Tel: +370 443 25451
Fax: +370 443 25455
E-mail: info@medinstrus.lt
Web: www.medinstrus.lt